



High speed

PROPERTIES

FEATURES

- ▶ for high speeds
- ▶ self centering conical clamping ring design
- ▶ high balancing grade

DESIGN

Two hubs with conical clamping ring and three or four screws. Maximum speed up to 120,000 rpm.

MATERIAL

- ▶ **Bellows:** high grade stainless steel
- ▶ **Hubs and clamping rings:** aluminium

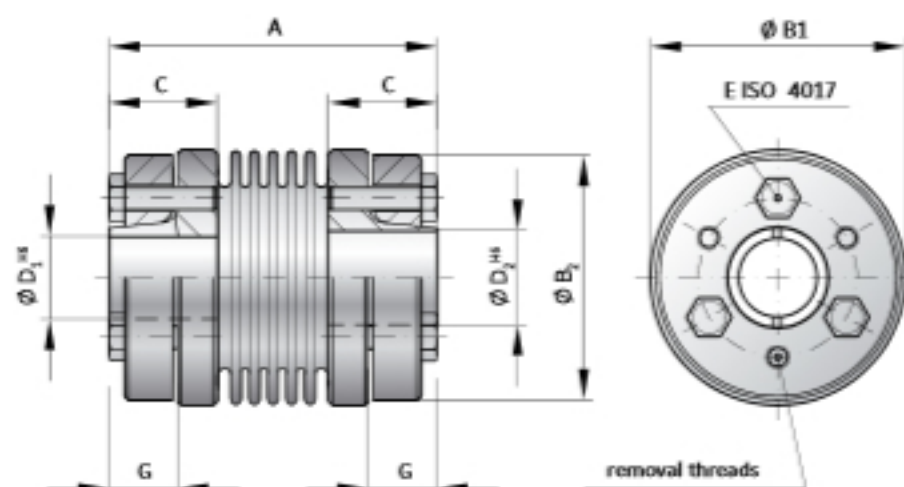

MODELL MKS

SIZE			45		100		150	
Rated torque	(Nm)	T_{OH}	4.5		10		15	
Overall length	(mm)	A	42		48		53	
Outside diameter	(mm)	B_1	32		40		49	
Outside diameter of hub	(mm)	B_2	30		38		46	
Fit length	(mm)	C	14		16		20	
Inside diameter possible from ϕ to ϕ H6	(mm)	D_{int}	6-10		8-14		10-19	
Fastening screw ISO 4017	(mm)	E	3x M3		4x M3		6x M3	
Tightening torque of the fastening screw	(Nm)		1.3		1.3		1.3	
Distance	(mm)	G	8.5		9.5		13	
Moment of inertia	(gcm^2)	J_{pol}	65		226		561	
Masse	(g)		51		103		171	
Torsional stiffness	(Nm/rad)	C_t	7000		9050		23000	
Axial	(mm)	Max. values	0.5		0.75		0.75	
Lateral	(mm)		0.1	0.05*	0.1	0.05*	0.1	0.05*
Angular	(degree)		0.5		0.5		0.5	

For speeds beyond 50,000 rpm use reduced misalignment values marked with *

ORDERING EXAMPLE	MKS	45	8	9.53	XX
Model	●				
Size		●			
Bore D1 H6			●		
Bore D2 H6				●	

Special designation only (e.g. special bore tolerance).

For custom features place an XX at the end of the part number and describe the special requirements (e.g. MKS / 45 / 8 / 9.53 / XX; XX=anodized aluminum hubs)