

**MK6**

# BLIND MATE WITH EXPANDING SHAFT

0.5 – 10 Nm

## PROPERTIES

### FEATURES

- ▶ easy installation and removal
- ▶ solution for mismatched bore / shaft diameters
- ▶ absolutely backlash free assembly

- ▶ **Tapered male segment:** high strength plastic
- ▶ **Clamping hub:** aluminium
- ▶ **Expanding shaft:** steel

### MATERIAL

- ▶ **Bellows:** high grade stainless steel

### DESIGN

One clamping hub with a tapered male projection for blind mate connection and one expanding shaft system.

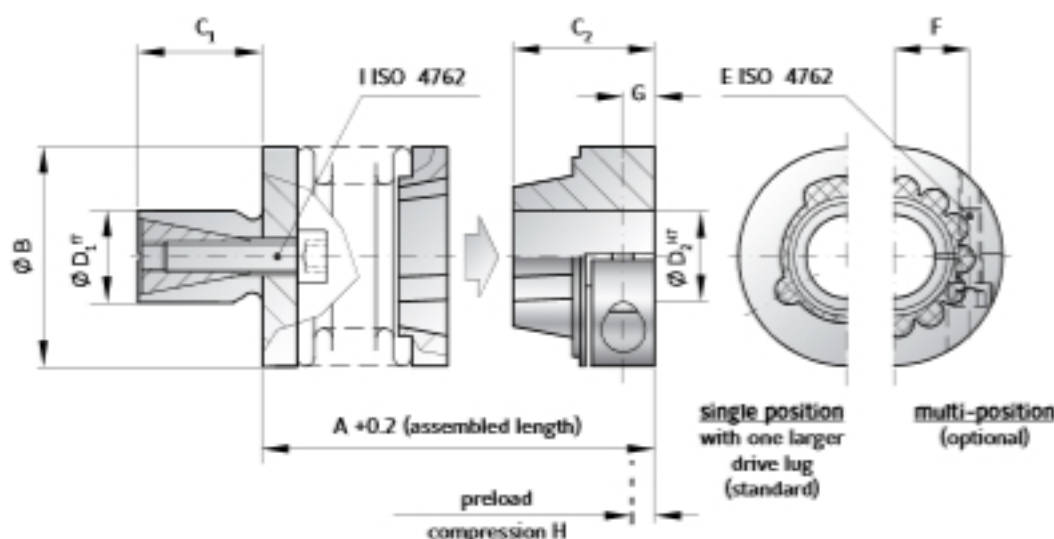

## MODEL MK6

SIZE	5			15		20			45		100	
Rated torque (Nm) $T_{RM}$	0.5			1.5		2			4.5		10	
Overall length (inserted) (mm) $A^{+0.2}$	21	24	27	27	32	28	34	38	38	46	45	55
Outside diameter (mm) B	15			19		25			32		40	
Shaft length (mm) $C_1$	10			12		12			15		20	
Fit length (mm) $C_2$	12			14		16			20		21.5	
Standard shaft $\phi$ f7 (mm) $D_1$	8-10			10-14		10-16			14-20		16-24	
Inside diameter possible from $\phi$ to $\phi$ H7 (mm) $D_2$	3-6.35			3-8		3-12.7			5-16		5-20	
Fastening screw ISO 4762	M2			M2.5		M3			M4		M4	
Tightening torque of the fastening screw (Nm) E	0.43			0.85		2.3			4		4.5	
Distance between centerlines (mm) F	4.5			6		8			10		15	
Distance (mm) G	3			3.5		4			5		5	
Preload compression (mm) H	0.4			0.5		0.5			0.7		1	
Axial recovery force at max. preload compression (N)	5	3	2	4	3	3	4	3	15	10	25	30
Fastening screw ISO 4762	M3			M4		M4			M5		M6	
Tightening torque of the fastening screw (Nm) I	1.5			3		4			6.5		11	
Moment of inertia (gcm <sup>2</sup> ) $J_{pm}$	3.0	3.2	3.5	9.0	10	28	30	33	110	120	220	230
Torsional stiffness (Nm/rad) $C_1$	280	210	170	750	700	1200	1300	1200	7000	5000	9050	8800
Lateral (mm) Max. values	0.15	0.2	0.25	0.15	0.2	0.15	0.2	0.25	0.2	0.25	0.2	0.3
Angular (degree)	1	1.5	2	1.5	1.5	1.5	1.5	2	1.5	2	1.5	2

ORDERING EXAMPLE	MK6	20	28	12	9.53	XX
Model	●					
Size		●				
Overall length mm			●			
Shaft D1 f7				●		
Bore D2 H7					●	
Special designation only (e.g. special bore / shaft tolerance).						

For custom features place an XX at the end of the part number and describe the special requirements (e.g. MK6 / 20 / 28 / 12 / 9.53 / XX; XX-finely balanced for 25,000 rpm)