

# FK1

# MICROFLEX WITH RADIAL SET SCREWS

## 1 Ncm

### PROPERTIES

#### FEATURES

- ▶ very small dimensions
- ▶ backlash free
- ▶ vibration damping

#### MATERIAL

- ▶ **Flex element:** high strength Polyamide
- ▶ **Hubs:** stainless steel

#### DESIGN

Two hubs with set screws mounted to a flex beam segment. Operational from  $-35^{\circ}$  to  $+80^{\circ}$  C. Speeds up to 20,000 rpm \*

#### SPECIAL SOLUTION

Effective outside diameter can be reduced to 4.5mm through the use of M2x1.5mm screws.

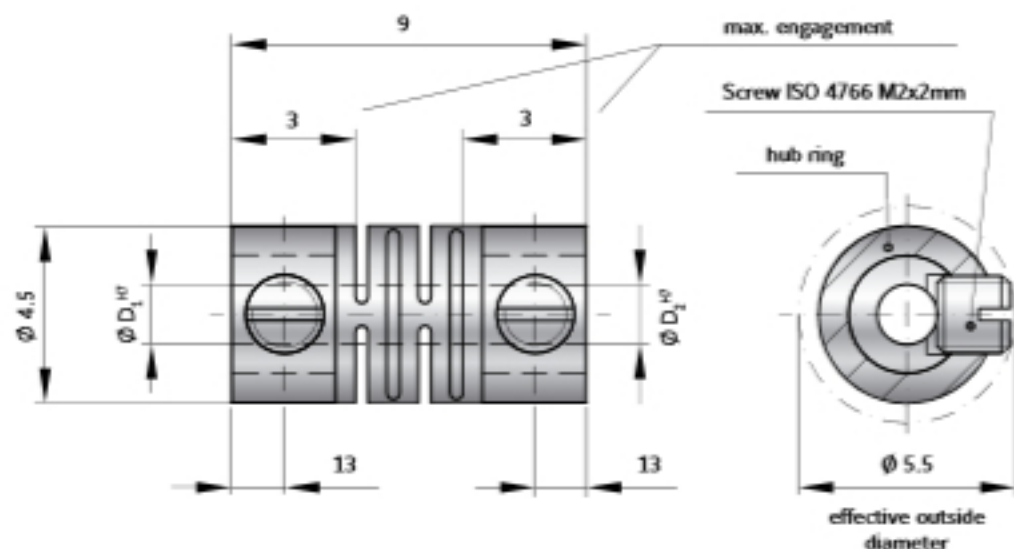

## MODEL FK1/001/9

### SIZE

Rated torque (Ncm)	$T_{RH}$	1
Standard bore H7 (mm)	$D_1, D_2$	1.5 / 1.5 or 2 / 1.5 additional bore diameters available upon request
Moment of inertia (gcm <sup>2</sup> )	$J_{pm}$	5.39
Approximate weight (g)		0.47
Torsional stiffness (Ncm/rad)	$C_t$	23 (measured at $+20^{\circ}$ C)
Axial (mm)	Max. values	0.2
Lateral (mm)		0.1
Angular (degree)		1.5

### COUPLING ASSEMBLY AND MOUNTING

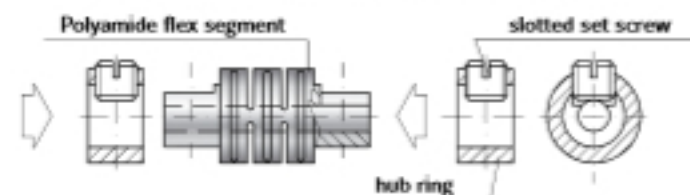

The screw threads through the clamping ring, through a slot in the flexible segment, and down onto the shaft, securing the entire assembly. Including a flat on the shaft can improve torque transmission.

**Caution:** Always use a precisely calibrated torque wrench during installation.

### DISMOUNTING

For dismounting, simply loosen the set screws and remove the coupling from the shafts.

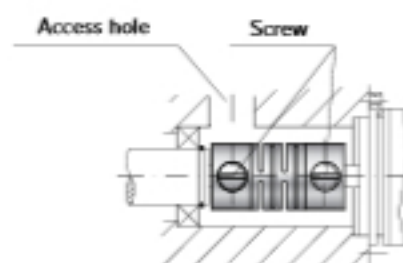

### ORDERING EXAMPLE

Model	FK1	001	9	1.5	1.5	XX
Size						Special designation only (e.g. special screw size).
Overall length mm						
Bore D1 H7						
Bore D2 H7						

For custom features place an XX at the end of the part number and describe the special requirements (e.g. FK1 / 001 / 9 / 1.5 / 1.5 / XX; XX-M2x1.5mm screws)